

SAFETY WARNINGS

- Warning for vulnerable consumer groups:** This product is not recommended for minors, pregnant or breast-feeding women or anyone at risk of heart disease, depression and asthma.
- Battery Caution:** Do not expose the device to extreme temperatures. Do not disassemble the device without Lost Vape's recommendation.
- Tank Attention:** Do not dry burn the tank or coil. It is essential to prime a new coil. Simply fill your tank with e-liquid and leave it to stand for at least 5 minutes before vaping. As above, this will allow the cotton inside your new coil to absorb plenty of e-liquid ready for that first, tasty vape. All tanks / coils are not covered under warranty once they are opened, used, or filled with liquids.
- Warranty:** The device is covered by a 3-month warranty from the date of purchase.
- Contacts:** For further questions or inquiries, please contact Lost Vape by email at support@lostvape.com or visit our website: www.lostvape.com.

MAIN FEATURE

- Unlimited Combination
- Feather Light 100+g
- 3-in-1 Jog Dial Interface
- Seamless Aluminium Alloy
- On/Off Toggle Switch

BASIC PARAMETERS

Dimension	92.7*38*26mm
Net Weight	100±5(g)
Battery	Single 18650 Battery (Not Included)
Coil Resistance Supported	0.1Ω-3.0Ω

ENGLISH

Battery Voltage	3.0V-4.2V
Power Range	5-100W
Charging Voltage	5V/2A
Type-C Cable	Support 5V/2A Charger
Body Materi	Aluminium-Alloy & Stainless Steels

PRODUCT DESCRIPTION

COMPONENTS OVERVIEW

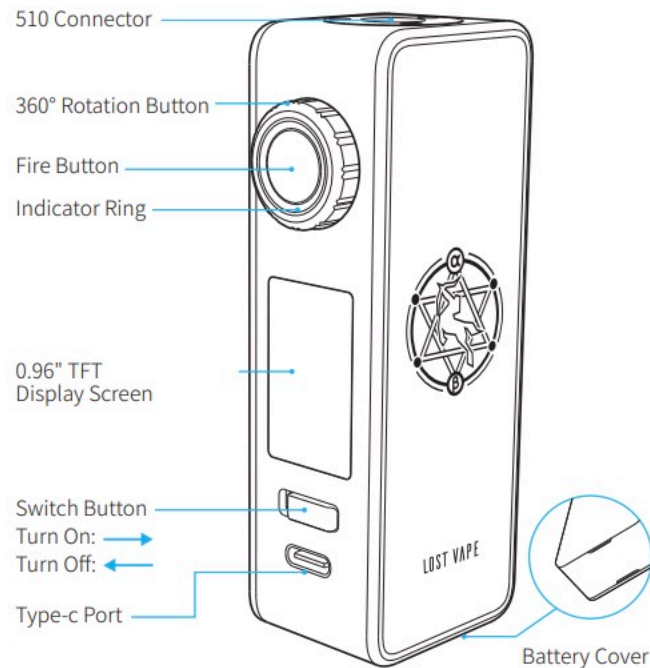

ENGLISH

SCREEN INFO OVERVIEW

NORMAL MODE

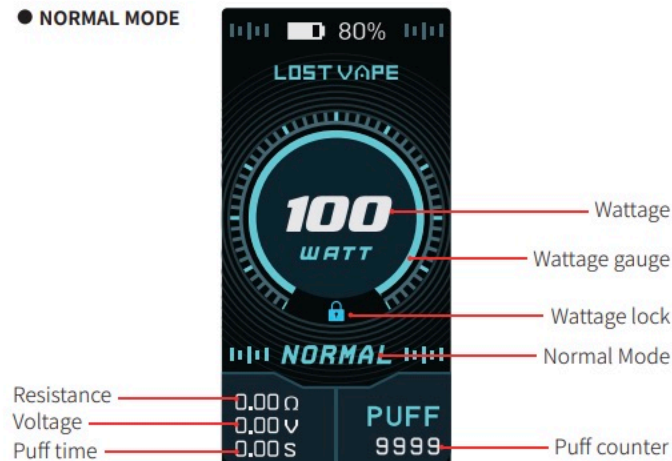

DIY MODE

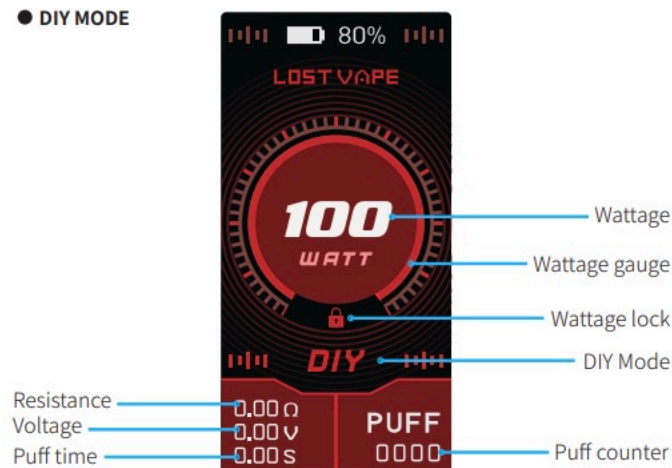

ENGLISH

BASIC OPERATION

TURN ON/TURN OFF

Push-Right the Switch Button to TURN ON the device & Push-Left to TURN OFF.

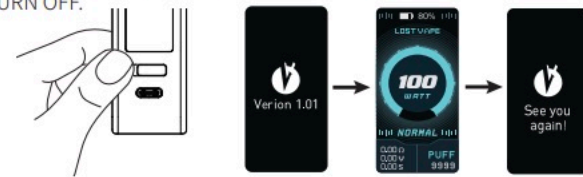

CHECK THE BATTERY LEVEL

The LED indicators will flash while vaping or charging to remain the battery capacity.

- 0% - 20%
- 20% - 40%
- 40% - 60%
- 60% - 80%
- 80% - 100%

HOW TO ADJUST WATTAGE

Turn round the Rotation Button to enter into power adjust mode. Clockwise the Rotation button increments power by step (The Incremental steps: 5-39W 1W, 40W-98W 2W).

Minimum 5W and Maximum 100W can be adjusted cyclically.



ENGLISH

SWITCH BETWEEN MODES

1) Press the Fire button 3 times consistently within 2 seconds to Lock / Unlock the wattage adjustment function. The Fire button will still work under this setting.



2) Under the unlock state of the wattage adjustment function, press the Fire button 5 times within 2 seconds to switch to Normal Mode / RDA DIY Mode.



PUFF TIME DISPLAY & PUFF COUNT RESET

- 1) Puff Time displays 0.0S-9.9S after every vaping, the peak display of puff count is 9999.
- 2) In the power-off state, press the Fire Button & turn on the Switch Button to reset the puff count.

DESCRIPTION OF WARNING

Low Battery: This message means battery level is 0% before use or when you are using, the output will automatically turn off and the indicator will flash 3 times with purple light. Please change battery.

Check Atomizer: It means no atomizer detected, or the atomizer resistance is higher than 3Ω. Press the fire button, the screen shows "Check Atomizer" and the indicator will flash 3 times with purple light.

Short Circuit: It means the atomizer resistance is lower than 0.08Ω. Press the fire button, the screen shows "Short Circuit" and the indicator will flash 3 times with purple light.

Too Hot: The device will shut down when the temperature of the internal board is higher than 85°C. The screen shows "Too Hot" and the indicator will flash 3 times with purple light. You can use the device again when the temperature is back to 65°C.

Over 10s: Output automatically shuts off and screen shows "Over 10s" with purple light 3 times when vaping over 10s continuously.

ENGLISH